



Art. 1870 Valvole di ritegno a clapet serie API 600 – BS 1868 scartamenti ANSI B16.10, flange ANSI B16.5, oppure a saldare Butt Welding ANSI B16.25, test in conformità a API 598. Prodotte in WCB, WC6, WC9, CF8, CF8M, CF3, CF3M, CN7M, LC1, LC2, LC3, LCB, LCC, Monel, 20# Alloys, 4°, 5°, C95800, C95500, e altri materiali a richiesta. Corpo con API monogram e CE



Art. 1870 Swing check valves series API 600 – BS 1868 face-to-face ANSI B16.10, flanges B16.5, or Butt Welding ANSI B16.25. Test in conformity to API 598. Produced in WCB, WC6, WC9, CF8, CF8M, CF3, CF3M, CN7M, LC1, LC2, LC3, LCB, LCC, Monel, 20# Alloys, 4°, 5°, C95800, C95500, and other materials on request. Body with API monogram and CE.



CE-1521-1
CE-1521-2
CE-1521-3
CE-1521-4
CE-1521-5



*Eugitive
Emission
Test
Certificates
ISO 15848-1*

Manufacturing Standards

API 6D, 600, 598, 591, 602, 6FA, 594, 6A
ISO 14313, 10497, 5752, 7259, 5996, 7005, 5210, 5211, 520
ANSI-ASME B16.34, B16.10, B16.20, B16.25, B16.5, B16.47, B16.42, B1.1, B16.1
AWWA C500, C501, C508, C509
AWS 5.9, AWS 5.1, AWS 5.4, AWS 5.5, AWS 5.13, AWS 5.14, AWS 5.15
MSS SP45, SP6, SP9, SP25, SP41, SP55, SP82, SP85, SP70, SP71, SP101, SP102, SP44
ASTM A105, A126, A182, A193, A194, A216, A217, A320, A350, A351, A352, A395, A488, A536
BS 1414, 1873, 1868, 5146, 1560, 5152, 5153, 5159, 5352, 6755
NACE MR0175

EURA srl

Via Bissolati, 6 20125 Milano - Tel +39 02.89.05.26.98 Fax +39 02.68.87.635
sales@euraitaly.com - www.euraitaly.com

SWING CHECK VALVES API6D ANSI 150 in carbon steel, dimensions:

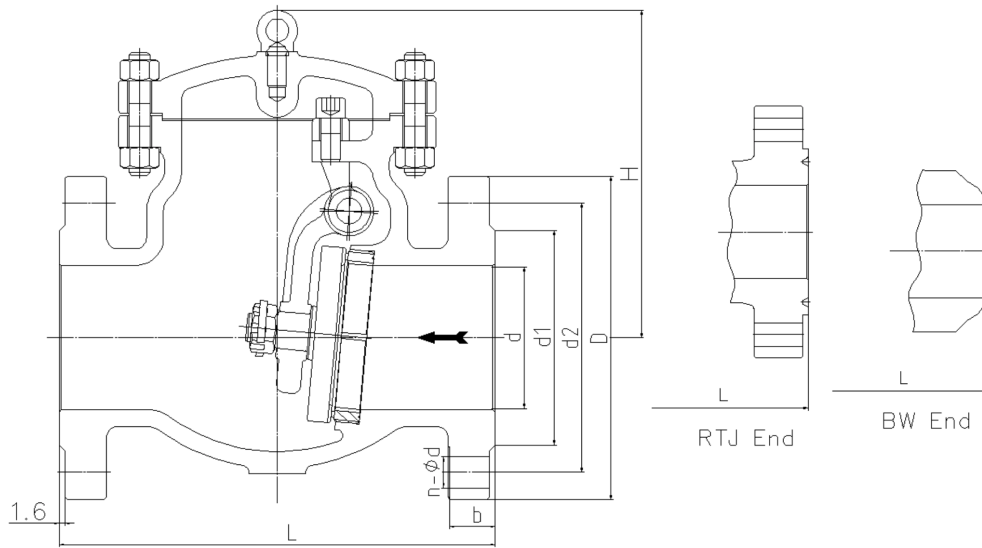

NPS	in	2	2 1/2	3	4	5	6	8	10	12	14	16	18	20	24
d	mm	51	64	76	102	127	152	203	254	305	337	387	438	489	591
L(RF)	mm	203	216	241	292	330	356	495	622	699	787	864	978	978	1295
L(BW)	mm	203	216	241	292	330	356	495	622	699	787	864	978	978	1295
L(RTJ)	mm	216	229	254	305	343	368	508	635	711	800	876	991	991	1308
d1	mm	92	105	127	157	186	216	270	324	381	413	470	533	584	692
d2	mm	120.5	139.5	152.5	190.5	216	241.5	298.5	362	432	476	540	578	635	749.5
D	mm	152	178	190	229	254	279	343	406	483	533	597	635	699	813
b	mm	16	18	19	24	24	26	29	31	32	35	37	40	43	48
n-φd	mm	4-19	4-19	4-19	8-19	8-22	8-22	8-22	12-25	12-25	12-29	16-29	16-32	20-32	20-35
H	mm	132	147	176	198	255	320	380	440	480	530	580	618	657	760



CE-1521-1
CE-1521-2
CE-1521-3
CE-1521-4
CE-1521-5



**Fugitive
Emission
Test
Certificates
ISO 15848-1**

SWING CHECK VALVES API6D ANSI 300 in carbon steel, dimensions:

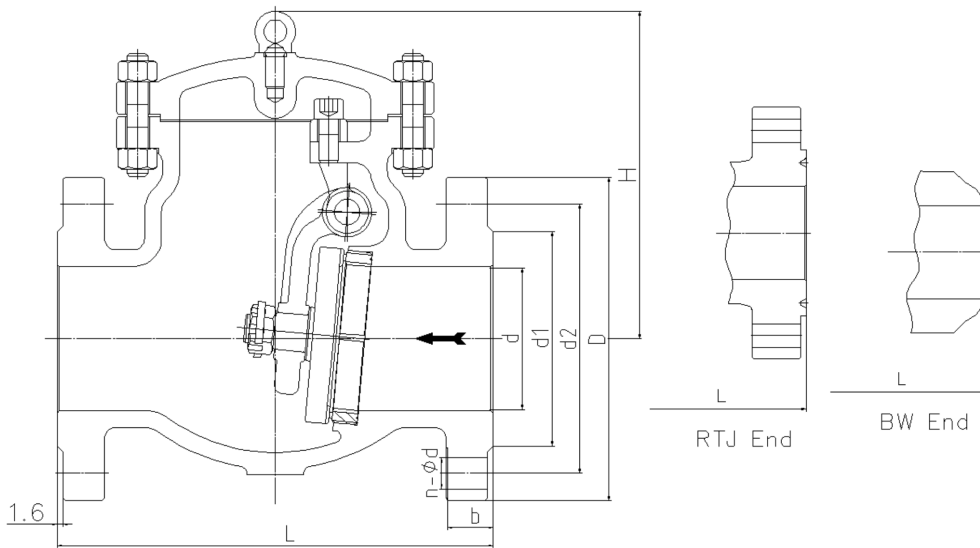

NPS	in	2	2 1/2	3	4	5	6	8	10	12	14	16	18	20	24
d	mm	51	64	76	102	127	152	203	254	305	337	387	432	483	584
L(RF)	mm	267	292	318	356	400	445	533	622	711	838	864	978	1016	1346
L(BW)	mm	267	292	318	356	400	445	533	622	711	838	864	978	1016	1346
L(RTJ)	mm	283	308	333	371	416	460	549	638	727	854	879	994	1035	1368
d1	mm	92	105	127	157	186	216	270	324	381	413	470	533	584	692
d2	mm	127	149	168.5	200	235	270	330	387.5	451	514.5	571.5	628.5	686	813
D	mm	165	190	210	254	279	318	381	445	521	584	648	711	775	914
b	mm	23	26	29	32	35	37	42	48	51	54	58	61	64	70
n-φd	mm	8-19	8-22	8-22	8-22	8-22	12-22	12-25	16-29	16-32	20-32	20-35	24-35	24-35	24-41
H	mm	144	149	210	260	295	326	380	440	520	540	588	670	720	850



CE-1521-1
CE-1521-2
CE-1521-3
CE-1521-4
CE-1521-5



**Eugitive
Emission
Test
Certificates
ISO 15848-1**

SWING CHECK VALVES API6D ANSI 600 in carbon steel, dimensions:

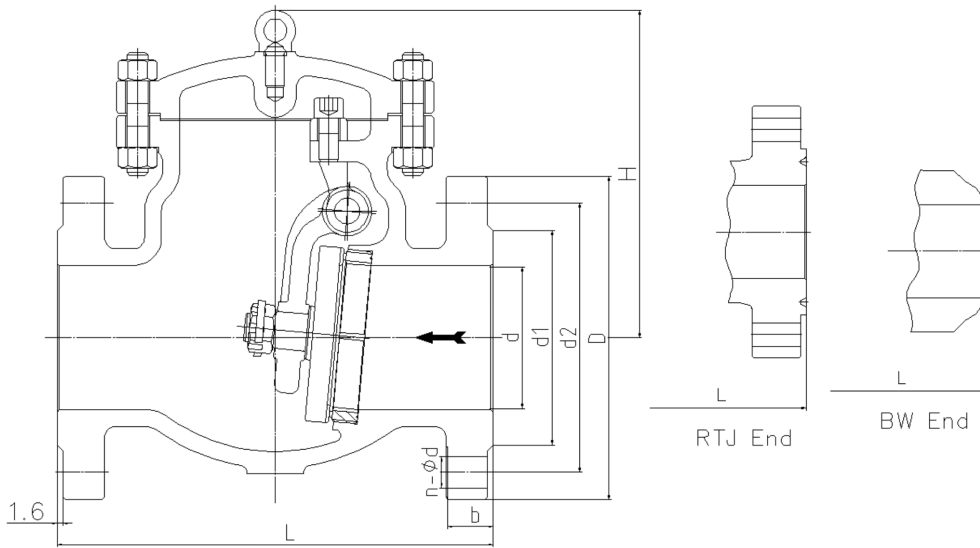

NPS	in	2	2 1/2	3	4	5	6	8	10	12	14	16	18	20	24
d	mm	51	64	76	102	127	152	200	248	298	327	375	419	464	559
L(RF)	mm	292	330	356	432	508	559	660	787	838	889	991	1092	1194	1397
L(BW)	mm	292	330	356	432	508	559	660	787	838	889	991	1092	1194	1397
L(RTJ)	mm	295	333	359	435	511	562	664	791	841	892	994	1095	1200	1407
d1	mm	92	105	127	157	186	216	270	324	381	413	470	533	584	692
d2	mm	127	149	168.5	216	267	292	349	432	489	527	603	654	724	838
D	mm	165	190	210	273	330	356	419	508	559	603	686	743	813	940
b	mm	26	29	32	38	45	48	56	64	67	70	77	83	89	102
n-φd	mm	8-19	8-22	8-22	8-25	8-29	12-29	12-32	16-35	20-35	20-38	20-41	20-44	24-44	24-52
H	mm	170	178	246	290	320	360	430	502	554	595	680	778	970	1100



CE-1521-1
CE-1521-2
CE-1521-3
CE-1521-4
CE-1521-5



**Eugitive
Emission
Test
Certificates
ISO 15848-1**

SWING CHECK VALVES API6D ANSI 900 in carbon steel, dimensions:

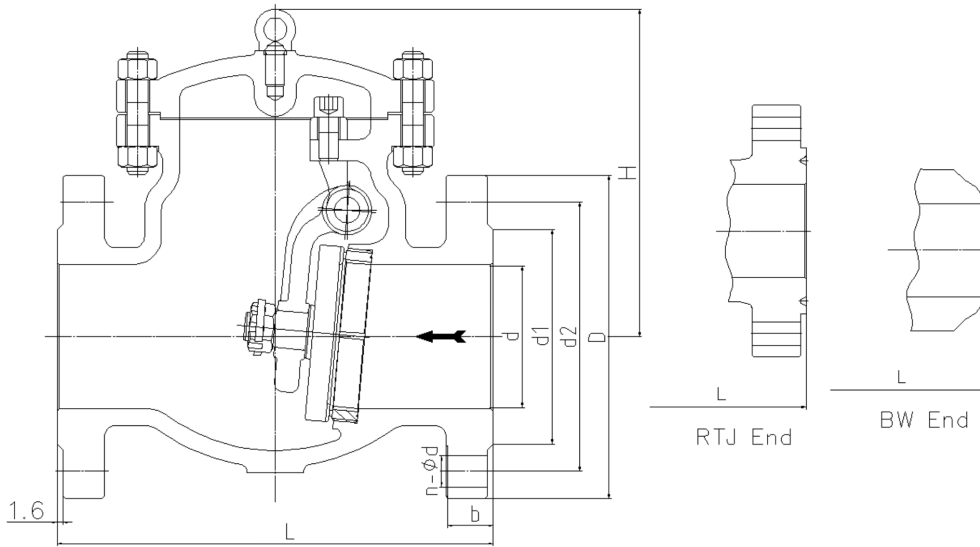

NPS	in	2	2 1/2	3	4	5	6	8	10	12	14	16	18	20	24
d	mm	47	57	73	98	121	146	190	234	282	311	354	400	444	533
L(RF)	mm	368	419	381	457	559	610	737	838	965	1029	1130	1219	1321	1549
L(BW)	mm	368	419	381	457	559	610	737	838	965	1029	1130	1219	1321	1549
L(RTJ)	mm	371	422	384	460	562	613	740	841	968	1038	1140	1232	1334	1568
d1	mm	92	105	127	157	186	216	270	324	381	413	470	533	584	692
d2	mm	165	190.5	190.5	235	279.4	317.5	393.7	469.9	533.4	558.8	615.9	685.8	749.3	901.7
D	mm	216	244	241	292	349	381	470	545	610	640	705	785	855	1040
b	mm	38.5	41.5	38.5	44.5	51	56	64	70	79.5	86	89	102	108	140
n-φd	mm	8-26	8-29	8-26	8-32	8-35	12-32	12-39	16-39	20-39	20-42	20-45	20-51	20-54	20-67
H	mm	200	220	280	320	360	400	480	560	630	680	780	880	1050	1200



CE-1521-1
CE-1521-2
CE-1521-3
CE-1521-4
CE-1521-5



**Fugitive
Emission
Test
Certificates
ISO 15848-1**

SWING CHECK VALVES API6D ANSI 1500 in carbon steel, dimensions:

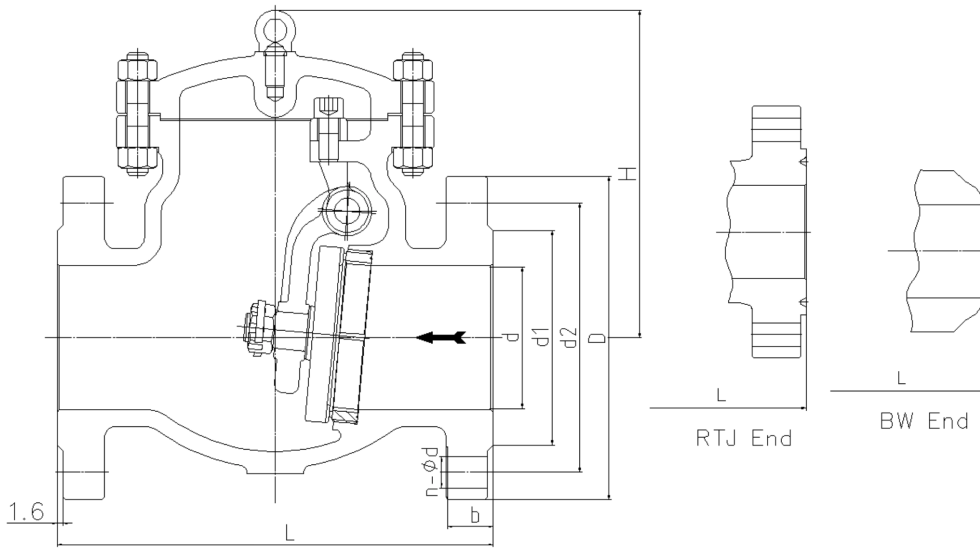

NPS	in	2	2 1/2	3	4	5	6	8	10	12	14	16
d	mm	47	57	70	92	111	136	178	222	263	289	330
L(RF)	mm	368	419	470	546	673	705	832	991	1130	1257	1384
L(BW)	mm	368	419	470	546	673	705	832	991	1130	1257	1384
L(RTJ)	mm	371	422	473	549	676	711	841	1000	1146	1276	1407
d1	mm	92	105	127	157	186	216	270	324	381	413	470
d2	mm	165	190.5	203.2	241.3	292.1	317.5	393.7	482.6	571.5	635	704.8
D	mm	216	244	267	311	375	394	483	585	675	750	825
b	mm	38.5	41.5	48	54	73.5	83	92.9	108	124	133.5	146.5
n-φd	mm	8-26	8-29	8-32	8-35	8-42	12-39	12-45	12-51	16-54	16-61	16-67
H	mm	210	240	303	340	380	430	500	590	660	710	820



CE-1521-1
CE-1521-2
CE-1521-3
CE-1521-4
CE-1521-5



***Fugitive
Emission
Test
Certificates
ISO 15848-1***

**SWING CHECK VALVES API6D ANSI 2500 in carbon steel,
dimensions:**

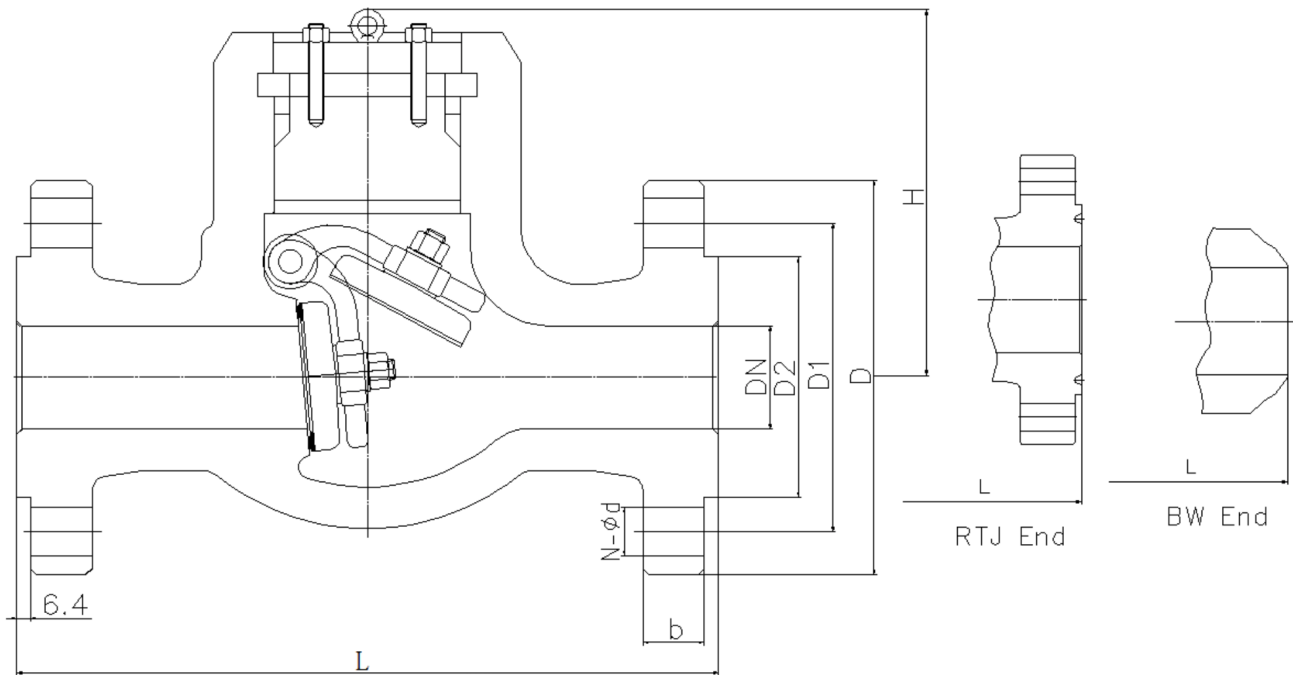

NPS	in	2	2 1/2	3	4	5	6	8	10	12
d	mm	38	47	57	73	92	111	146	184	219
L(RF)	mm	451	508	578	673	794	914	1022	1270	1422
L(BW)	mm	451	508	578	673	794	914	1022	1270	1422
L(RTJ)	mm	454	514	584	683	807	927	1038	1292	1445
d1	mm	92	105	127	157	186	216	270	324	381
d2	mm	171.4	196.8	228.6	273	323.8	368.3	438.1	539.7	619.1
D	mm	235	267	305	356	419	483	550	675	760
b	mm	51	57.5	67	76.5	92.5	108	127	165.5	184.5
n-φd	mm	8-29	8-32	8-35	8-42	8-48	8-54	12-54	12-67	12-74
H	mm	230	260	330	370	410	460	530	620	690



CE-1521-1
CE-1521-2
CE-1521-3
CE-1521-4
CE-1521-5



**Eugitive
Emission
Test
Certificates
ISO 15848-1**

EURA srl

Via Bissolati, 6 20125 Milano - Tel +39 02.89.05.26.98 Fax +39 02.68.87.635
sales@euraitaly.com - www.euraitaly.com

Art. 1870 Valvole di ritegno a clapet serie API 600 – BS 1868 scartamenti ANSI B16.10, flange ANSI B16.5, oppure a saldare Butt Welding ANSI B16.25, test in conformità a API 598. Prodotte in WCB ·WC6 ·WC9 ·CF8 ·CF8M ·CF3 ·CF3M CN7M, LC1, LC2, LC3, LCB, LCC, Monel, 20# Alloys, 4°, 5°, C95800, C95500, e altri materiali a richiesta. Corpo con API monogram e CE

Art. 1870 Swing check valves series API 600 – BS 1868 face-to-face ANSI B16.10, flanges B16.5, or Butt Welding ANSI B16.25. Test in conformity to API 598. Produced in WCB ·WC6 ·WC9 ·CF8 ·CF8M ·CF3 ·CF3M CN7M, LC1, LC2, LC3, LCB, LCC, Monel, 20# Alloys, 4°, 5°, C95800, C95500, and other materials on request. Body with API monogram and CE.

TRIM: API NORMS

Internal parts-API nr.	Seat ring or body	Gate ·disc ·ball or body	Stem	No of internal parts API nr.	Seat ring or body	Gate ·disc ·ball or body	Stem
1	13Cr	13Cr	13Cr	31	STELLITE	321SS	321SS
2	304SS	304SS	304SS	32	STELLITE	STELLITE	321SS
3	310SS	310SS	310SS	33	347SS	347SS	347SS
4	HARD 13Cr	HARD 13Cr	13Cr	34	STELLITE	347SS	347SS
5	STELLITE	STELLITE	13Cr	35	NICKEL ALLOY	13Cr	13Cr
6	Cu-Ni	13Cr	13Cr	36	A105/PTFE	A105+ENP	A105+ENP
7	13Cr	HARD 13Cr	13Cr	37	A105/PTFE	WCB+ENP	A105+ENP
8	STELLITE	13Cr	13Cr	38	13Cr/PTFE	13Cr	13Cr
9	Cu-Ni	Cu-Ni	Cu-Ni	39	304SS/PTFE	304SS	304SS
10	316SS	316SS	316SS	40	316SS/PTFE	316SS	316SS
11	Cu-Ni	STELLITE	Cu-Ni	41	A105/RPTFE	A105+ENP	A105+ENP
12	STELLITE	316SS	316SS	42	A105/RPTFE	WCB+ENP	A105+ENP
13	ALLOY 20	ALLOY 20	ALLOY 20	43	13Cr/RPTFE	13Cr	13Cr
14	STELLITE	ALLOY 20	ALLOY 20	44	304SS/RPTFE	304SS	304SS
15	STELLITE	STELLITE	304SS	45	316SS/RPTFE	316SS	316SS
16	STELLITE	STELLITE	316SS	46	A105/NYLON	A105+ENP	A105+ENP
17	STELLITE	STELLITE	347SS	47	A105/NYLON	WCB+ENP	A105+ENP
18	STELLITE	STELLITE	ALLOY 20	48	A105/NYLON	304SS	304SS
19	MONEL	MONEL	MONEL	49	A105/NYLON	316SS	316SS
20	BRONZE	BRONZE	13Cr	50	13Cr/NYLON	13Cr	13Cr
21	HASTELLOY B	HASTELLOY B	HASTELLOY B	51	304SS/NYLON	304SS	304SS
22		HASTELLOY C	HASTELLOY C	52	316SS/NYLON	316SS	316SS
23	STELLITE	304SS	304SS	53	A105/PEEK	A105+ENP	A105+ENP
24	304LSS	304LSS	304LSS	54	A105/PEEK	WCB+ENP	A105+ENP
25	STELLITE	304LSS	304LSS	55	13Cr/PEEK	13Cr	13Cr
26	STELLITE	STELLITE	304LSS	56	304SS/PEEK	304SS	304SS
27	316LSS	316LSS	316LSS	57	316SS/PEEK	316SS	316SS
28	STELLITE	316LSS	316LSS				
29	STELLITE	STELLITE	316LSS				
30	321SS	321SS	321SS				